

# Setting-up Guide



**CAUTION**  
RISK OF ELECTRIC SHOCK  
DO NOT OPEN



**CAUTION: To reduce the risk of electric shock, do not remove cover (or back).  
No User-serviceable parts inside.  
Refer servicing to qualified service personnel.**

**WARNING:** To prevent fire or electric shock, do not expose this appliance to rain or moisture. Do not expose this equipment to dripping or splashing and ensure that no objects filled with liquids, such as vases, are placed on the equipment.

To completely disconnect this equipment from the AC Mains, disconnect the power supply cord plug from the AC receptacle.



This symbol indicates that a dangerous voltage constituting a risk of electric shock is present within this unit.



This symbol indicates that there are important operating and maintenance instructions in the literature accompanying this unit.

#### **For the US-market only!**

**NOTE:** This equipment has been tested and found to comply with the limits for a class B digital device, pursuant to part 15 of the FCC Rules. These limits are designed to provide reasonable protection against harmful interference in a residential installation.

This equipment generates, uses and can radiate radio frequency energy and, if not installed and used in accordance with the instructions, may cause harmful interference to radio communications. However, there is no guarantee that interference will not occur in a particular installation. If this equipment does cause harmful interference to radio or television reception, which can be determined by turning the equipment off and on, the user is encouraged to try to correct the interference by one or more of the following measures:

- Reorient or relocate the receiving antenna.
- Increase the separation between the equipment and receiver.
- Connect the equipment into an outlet on a circuit different from that to which the receiver is connected.
- Consult the dealer or an experienced radio/TV technician for help.

---

#### **For the Canadian market only:**

This class B digital apparatus meets all requirements of the Canadian Interference-Causing Equipment Regulations.



*This product fulfils the conditions stated in the EEU directives 89/336 and 73/23.*

*Technical specifications, features and the use thereof are subject to change without notice.*

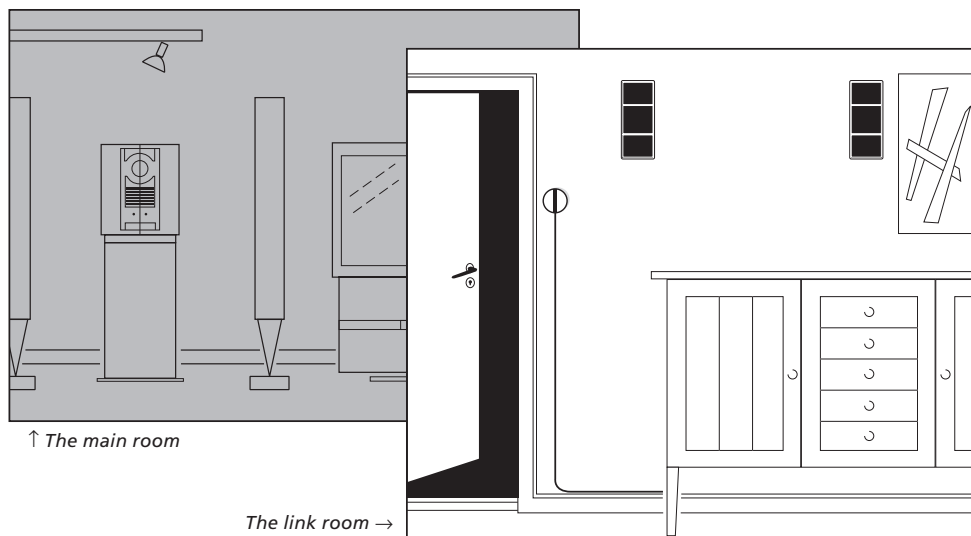

This guide describes how to install your BeoLink Passive kit in a BeoLink (Master Link) distribution system.

The User's guide, which is also supplied with the BeoLink Passive kit, describes how to operate the system once it has been installed.

The BeoLink distribution system enables you to control your main system and to listen to it in the link room. Your link room must be connected to the main room via a Master Link cable. To join the Master Link cables from the main system and from the BeoLink Passive kit, a junction box is required.

The cable and box (and other accessories) can be purchased at your Bang & Olufsen dealer.

*The main room* is the room in which you have placed your audio system and/or video system (the main system).

*The link room* is where you are about to install your BeoLink Passive kit.

When you set up your BeoLink Passive, we recommend the following sequence:

- 1 Switch off your Bang & Olufsen system and disconnect the products from the mains.
- 2 Make the installation as described in this guide.
- 3 Connect the entire system to the mains.

We recommend that you follow the instructions in this guide carefully. If you have never carried out cable installations before, we suggest you leave it to your Bang & Olufsen retailer.

#### Contents

- 4 Placement
- 7 Connections
- 9 Ready for use...
- 10 Maintenance

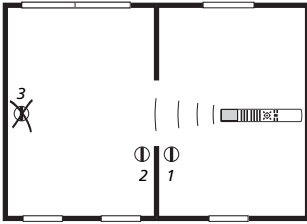

If you have installed more units throughout the house, make sure that the remote control can only activate one receiver at a time.

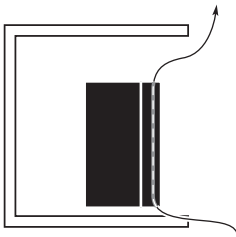

Place the amplifier box on a stable surface, e.g. on a non-carpeted floor, a shelf, or at the bottom of a cupboard. Allow a space of approx. 5 cm (2") above the amplifier box for adequate ventilation.

### Planning your installation

The BeoLink Passive kit consist of these two main parts:

- The BeoLink Passive receiver (close-up operation panel and receiver for the remote control signals).
- The BeoLink Passive amplifier box.

In the following we have listed some advice and requirements for the placement of the BeoLink Passive parts:

- Before you start make sure you have all the necessary cables, junction boxes, screws, wall plugs, etc. If in doubt, please contact your Bang & Olufsen retailer.
- Do not connect any units in your system to the mains, before you have made the connections.
- The units in the system must all be placed in a dry place, i.e. not outdoors (the cables, however, may very well be run outdoors).

### ■ The BeoLink Passive receiver:

- The receiver is designed to function within a temperature range of 0–55°C (32–130°F). If it is exposed to higher or lower temperatures, it may block the whole system.
- Avoid placing the receiver in direct sunlight or direct artificial light (e.g. a spotlight), or near objects generating electrical noise (e.g. dimmers), as this may reduce the sensitivity of the remote control receiver.
- The receiver cable supplied is 5 metres (15'). If you need a longer cable, you must use a special low capacity cable. This cable can be purchased at you Bang & Olufsen retailer (*part no. 6270668, length 15 metres – 50'*).
- Place the receiver so it can receive the remote control signals.
- If the receiver is placed next to a door and in a suitable height, you can easily switch on or off on its close-up operation panel, when entering or leaving the room. Likewise, if it is placed near your telephone, you can switch off the speakers while you are on the phone.

■ *The BeoLink Passive amplifier box:*

- The amplifier box is designed to function within a temperature range of 10–40°C (50–105°F).
- For safety reasons, the mains cord *must be* secured to the amplifier box as explained on page 7.
- If you are going to hang the amplifier box on a wall always use the correct size and type of screws and wall plugs to support the weight of the amplifier box (depending on the material and the construction of the wall). If in doubt, consult your Bang & Olufsen retailer.

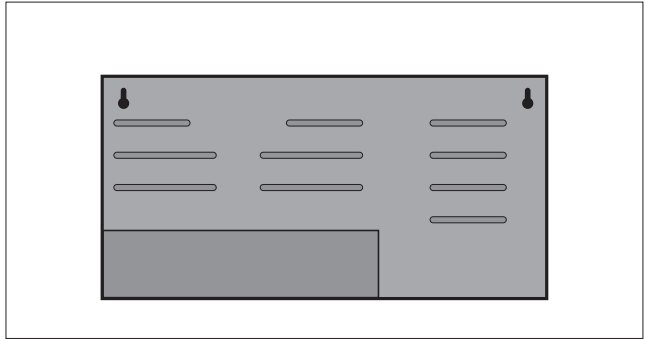

**Fixing the amplifier box to the wall**

The rear part of the amplifier box has been furnished with two 'keyholes', which may be used to fasten the box to e.g. a wall.

Note! Light partition walls are often constructed of gypsum panels – known as drywall or wall board – secured to vertical studs. *Gypsum is not a satisfactory material to support the weight of the amplifier box!* If you wish to fix the BeoLink Passive amplifier box on such a wall, be sure to use the correct size and type of screws and plugs.

### Fixing the receiver to the wall

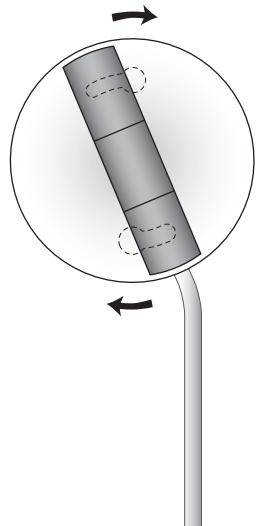
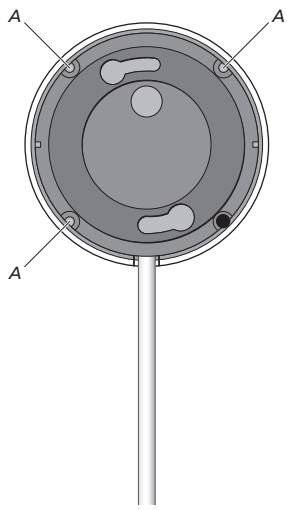
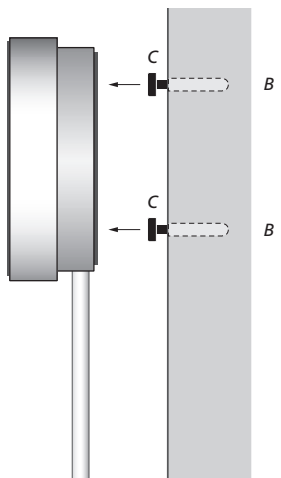
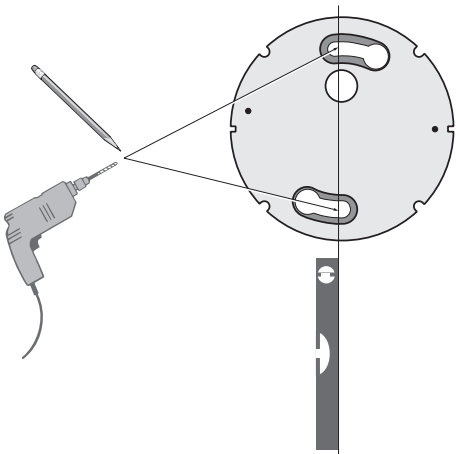
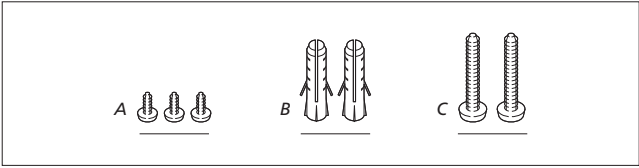

**BeoLink Passive receiver**

Use the cable supplied (or the optional special low capacity cable mentioned on page 4) and connect the BeoLink Passive receiver as explained here:

- 1 Cut the cable to the required length (from the BeoLink Passive amplifier box to the receiver) and strip it as shown.
- 2 Insert the cable end through the cable clamp (*F*) and connect the leads to the terminals inside the receiver in the order indicated. Then tighten the clamp (*F*).
- 3 Attach the rear cover and fix the BeoLink Passive receiver to the wall as explained on page 5.
- 4 Plug the cable into the socket marked IR on the BeoLink Passive amplifier box.

All cables should be handled with great care. When running the cables, avoid bending them too sharply and be careful not to twist them. Avoid subjecting the cables to pressure or impact.

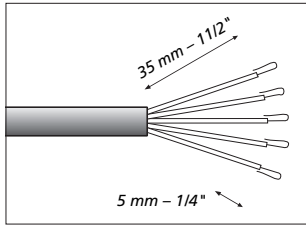

*Strip the receiver cable end. Twist the cores in each lead and bend them back.*

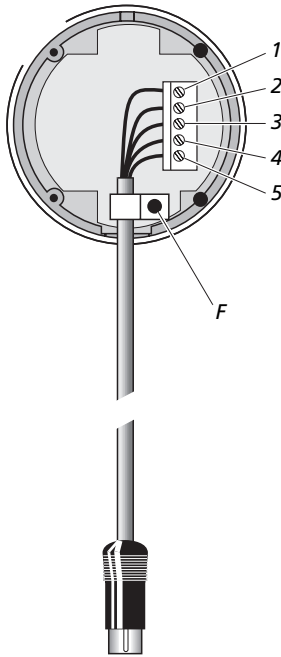

*Connect the leads in the receiver cable to the terminals inside the receiver in this order:*

- 1 = Yellow
- 2 = Grey
- 3 = Green
- 4 = White
- 5 = Brown

**BeoLink connections**

*In the main room:* Connect the Master Link cable to the socket marked MASTER LINK on your main system, and run the cable to the junction box.

*In the link room:* Connect the Master Link cable to the socket marked MASTER LINK on the BeoLink Passive amplifier box, and run the cable to the junction box.

*Inside the junction box:* Join the cables as explained in the folder enclosed with the box. The document contains information of the many possibilities of the box and how to join the cables.

**Loudspeaker connections**

Connect your passive loudspeakers to the sockets marked SPEAKERS L – R (left and right speaker, respectively) on the amplifier box.

*The socket marked POWER LINK should not be used in a BeoLink Passive setup.*

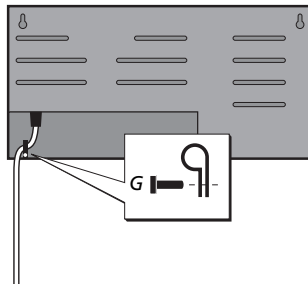
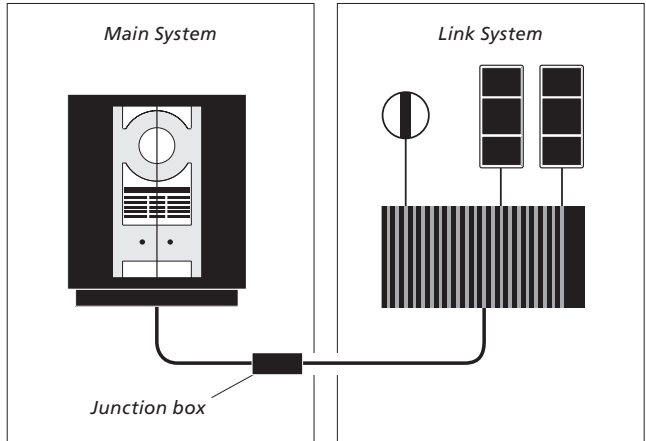
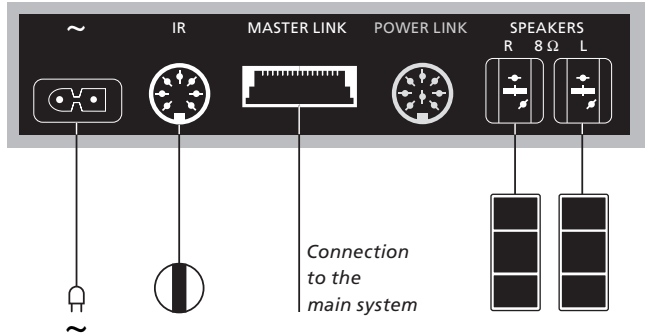

**Mains connection**

Plug the mains lead into the socket marked ~ on the BeoLink Passive amplifier box and secure it with the clamp (G).



When you have checked all the connections, connect your main system to the mains – and then the BeoLink Passive amplifier box.

Once connected to the mains, the BeoLink Passive is in stand-by mode. The amplifier box switches on and off automatically, and is designed to be left in stand-by mode when not in use.

Normally, the BeoLink Passive will now be ready for use. However, in special product setups, you may need to preprogram the setup.

The BeoLink Passive can be preprogrammed for the following setup situations (*Options*):

*Option 0:* To be used if you want to disable remote control operation of the BeoLink Passive (to enable remote control again, select one of the other options).

*Option 4:* To be used if you install the BeoLink Passive in the same room as your main system (e.g. in a large L-shaped living room with two separate listening positions).

*Option 5:* To be used if you install a TV set in the same room as you BeoLink Passive.

*Option 6:* To be used for a setup with your main system in one room and the BeoLink Passive in another, as described in this guide (this is the factory setting).

---

#### Using a Beo4:

- Hold the • button while pressing LIST.  
When the Beo4 display reads OPTION?, press GO.
- Press LIST to display L.OPT and then key in the appropriate number (0, 4, 5 or 6).

#### Using a Beolink 1000:

- Press LINK, the appropriate number (0, 4, 5 or 6), and then STORE.



---

*The preprogramming is done with a Bang & Olufsen remote control. It must be carried out with both the main- and the link system switched to stand-by!*

Clean the surfaces using a soft, lint-free cloth which you have wrung-out firmly in a solution of lukewarm water containing a few drops of mild household cleaner, for example a dish washing detergent.

The cooling grill on the front of the amplifier box may be cleaned using a soft brush and a vacuum cleaner.

*Never use alcohol or other solvents to clean any parts of your BeoLink Passive!*

